

---

## USING THE PROJECTOR

This section provides a reference for using the keypad and remote, as well as describing options available through the on-screen menus. This section also describes how to use and make adjustments to the projector for optimum performance.

### Basic Image Adjustment

- 1 Make sure you have powered up your equipment in the correct order. See page 17 for details.
- 2 If the image doesn't display completely, adjust the height of the projector, and then center the image horizontally. Now turn the zoom ring until the image fits into the viewing area. Be sure the projector is at a 90 degree angle to the screen.

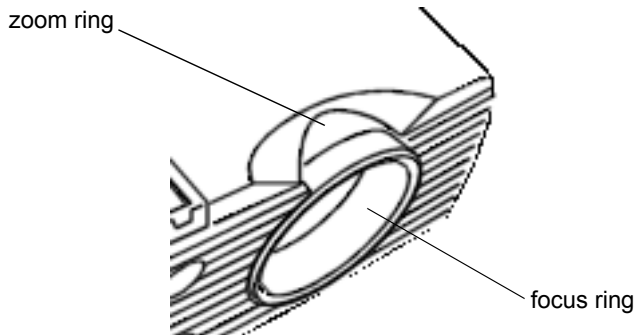

**FIGURE 4**

*Adjusting the zoom and focus on the projector*

- 3 If the image is out of focus, rotate the focus lens until the image is sharp.
- 4 If the image appears to shimmer or if it has blurry vertical bars after you have adjusted the focus, turn Auto Image (see details on page 30) off and then back on to reset the automatic sync and tracking. For additional information on adjusting the image, see the "Image Menu" beginning on page 29.
- 5 If the colors don't look bright, adjust the brightness and tint. See the "Display Menu" on page 26.

### Using the Remote Control

The LP630 comes with a full featured, multi-functional wireless remote control. The remote can control all projector functions, including some that are found only on the remote, operate your computers mouse, and comes with a laser pointer.

Point the remote control at the projection screen or at the front or rear of the projector (not the computer). The range for optimum operation is about 25 feet. If you point the remote at the projection screen, the distance to the screen and back to the projector should be less than 25 feet. For best results, point the remote directly at the front or rear of the projector.

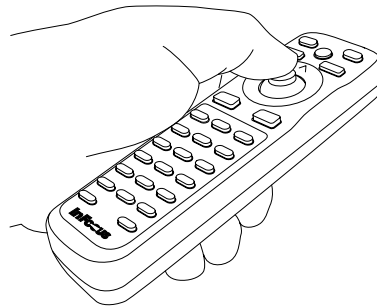

**FIGURE 5**

*Using the remote control*

### Using the Laser Pointer

To use the laser pointer, aim the remote at the viewing screen and press the laser button. The laser goes off when button pressure is released.

### Controlling your computers Mouse with the Remote

To control the computer's mouse using the remote, you must first connect the USB mouse connector (on the M1 cable) to the computer. See page 15 for details.

Apply pressure at any angle to the mouse button to move the cursor. The two buttons below and to the left and right of the mouse button are the left and right mouse buttons. To drag with the mouse, place the cursor in the object to move, press and hold down the left mouse button, and then apply pressure at any angle to the mouse button to move the cursor.



**CAUTION**

LASER RADIATION - DO NOT  
STARE INTO BEAM

WAVE LENGTH: 670nm  
MAX OUTPUT: < 1mW

CLASS II LASER PRODUCT

---

If you have a Microsoft® PowerPoint® presentation, you can use the remote's fwd and bkwd buttons to navigate forward and backward through your presentation while in the Slide Show mode.

### **Adjusting the Projector**

The projector is equipped with a self-locking, quick-release elevator foot and button and a leveling knob.

#### **To Raise the Projector**

- 1 Press and hold the elevator button.
- 2 Raise the projector to the desired height, and then release the button to lock the elevator foot into position. If necessary, turn the leveling knob at the rear of the projector to adjust the angle of the projected image.

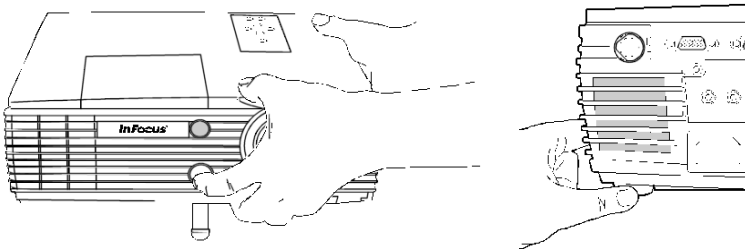

**FIGURE 6**

*Adjusting the height of the projector*



**CAUTION**  
 LASER RADIATION - DO NOT  
 STARE INTO BEAM  
 WAVE LENGTH: 670nm  
 MAX OUTPUT: < 1mW  
 CLASS II LASER PRODUCT

### Using the Keypad and Remote Buttons to navigate

With either the keypad on the projector or the remote, press the menu button.

**On the keypad,** use the source/standby buttons to move up and down in the menu. Once a menu selection has been made, press the menu button a second time to highlight the selection, and the volume + - buttons to move within the selection.

**On the remote,** use the up/down motion on the Disk mouse to move within the menu, press the menu button to highlight it, and the mouse button left/right motion to move within the selection.

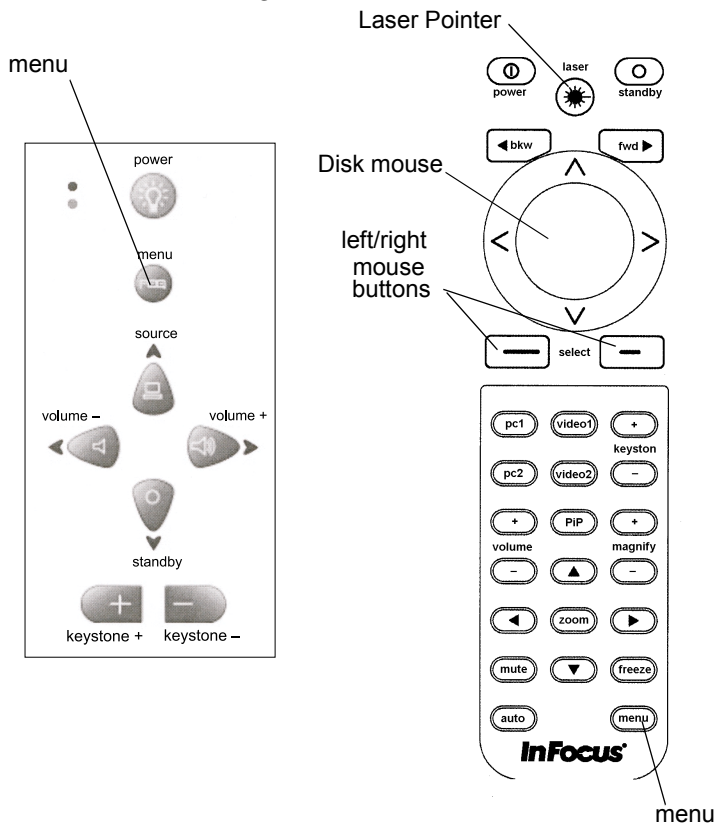

FIGURE 7

*Keypad and remote buttons*

---

## Using the Projector Keypad

The keypad has eight control buttons; power, menu, source, standby, volume -, volume +, keystone - and keystone +. The source, standby, volume left and volume right buttons double as left, right, up and down buttons when moving through the menus when you're in the menu mode. The arrow buttons can also be used for panning while in the zoom mode, and for window placement in the PIP mode.

### Arrow LED's

Green, arrow shaped LED's on the projector keypad are backlit when the projector is in the menu mode, indicating that the four arrow buttons are enabled for menu navigation.

### Menus

Press the menu button to display the projector menu. The menu includes the following information:

- **Display** – adjust keystone, brightness, tint, color, color temperature, contrast, and screen color.
- **Audio** – adjust volume, treble, bass, balance and fade. Access to mute sound.
- **Image** – resize (toggle between standard and native image size), overscan, video standard, image position indicates zoom and auto image selection, adjust manual sync, manual tracking, horizontal and vertical image.
- **Control** – set auto source, default source, standby timer and display message.
- **Advanced** – set rear project, ceiling project, screen saver, auto shutdown (time to), display startup screen and reset.
- **Language** – English, French, German, Spanish, Japanese, Chinese, and Korean.
- **Status** – indicates lamp hours used, computer resolution, signal source, speakers (internal/external) and the current software version.

### Using the Remote Control

The remote has the same buttons found on the projector keypad, and additional keys found only on the remote.

- **Fwd/Blk** – used for slide forward and slide backward in presentations created in Microsoft® PowerPoint®.
- **Arrow buttons** – used for panning while in the zoom mode or for window placement in the PIP mode.
- **Disk Mouse** – used in conjunction with the select buttons for menu navigation. The disk mouse becomes the remote mouse when the projector is not in the menu mode. When functioning as a remote mouse, the select buttons represent the left and right mouse buttons.
- **Auto** – used to toggle the Auto Image feature of the projector. This is the equivalent of turning Auto Image off then on again, adjusting and resyncing the image.
- **Menu** – opens the on-screen menu. Press again to close. When you close the menu, any changes you made were saved. For additional information, see page 26.
- **Zoom** – used to zoom in on a specific section of the image projected. You can increase and decrease the zoom, and move around in zoom mode.
- **PIP (Picture in Picture)** – Allows a video image to be overlaid on the main (background) screen. The image size can be changed and contain video from either video source. The video image can be moved anywhere on the screen. The feature is disabled when the PIP is pressed again.

- 
- **PC1/PC2** – data sources for the projector. Allows the user to have more than one presentation available during a presentation, drawing information from two sources individually.
  - **Video1/Video2** – video sources for the projector. Allows the user to have more than one video source available during a presentation.
  - **Magnify** – increases or decreases the size of the image being viewed. You must be in the zoom mode to use magnify. When in magnify, you can pan up, down, left and right. You must also be at least one magnification to pan.
  - **Freeze** – freezes the frame of the digital input, allowing for discussion or changing video sources. Does not freeze the video source.
  - **Standby** – turns display and audio off. Displays blank screen for 15 minutes or as set by the user.

If you press **standby** again within 15 minutes or as set by the user, the projector returns to normal operations immediately.

If you don't press **standby** again, the lamp turns off after 15 minutes or as set by the user, and the projector shuts off.

There is a 60 second delay before the lamp can be relit if it was just turned off.

### Using the On-Screen Menus

The projector has seven drop-down menus which allow you to make adjustments and changes to a variety of settings. The individual menus have been listed previous. The following is a functional description of each menu item.



**FIGURE 8**  
*Selections available on the projector menu*



**NOTE:** Some menu items may be grayed out (dimmed) at certain times. This indicates the item is not applicable to your setup (for example, video standards do not apply to computer sources) or the item is not enabled until another selection is made (for example, Manual Tracking is not available until Auto Image is turned off).

### Display Menu

Use the display menu to adjust keystone, brightness, tint, color, color temperature, and the default screen color.

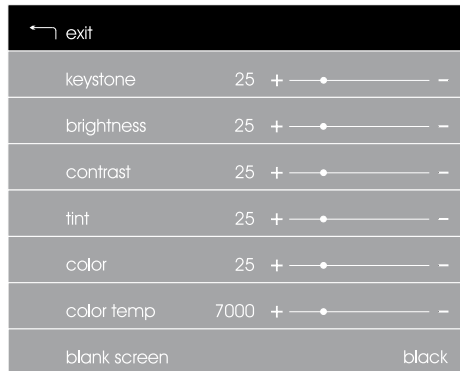

**FIGURE 9**  
*Selections available within the display menu*

---

### **Keystone + -**

The keystone buttons correct the distortion that is caused when one edge of the screen is further from the projector lens than the other. This condition could be caused either by a tilted screen or by the screen being above or below the level of the projector lens. Keystone correction works for both data and video sources. The keystone buttons will auto-repeat. A horizontal slider display appears on the screen when keystone is adjusted with the keystone buttons. The slider display provides a graphic indication of the setting from 0 to 100%

### **Brightness**

The brightness selection adjusts the overall intensity of illumination and determines the background level of the projected display. It does not affect the brightness of internally generated images such as the startup screens. Brightness increases when the slider is moved to the right.

### **Tint**

Tint adjusts the red/green balance of the display and determines the color of the projected image. Moving the slider to the left will increase the green. Moving the slider to the right will increase red.

### **Color**

The color selection adjusts the image from black and white to fully saturated color. Saturation increases when the slider is moved to the right.

### **Color Temperature**

The color temperature selection adjusts the white point of the display. In order to achieve pure white the user can manipulate the tone of white from blue-white to yellow (red-green)-white. Color temperature is shifted toward blue when the slider is moved to the right.

### **Screen Color**

When the projector has no display signal, the screen will appear blue (the default), black or white. Select screen color and then use the mouse left/right motion on the remote or the volume +/- on the keypad to toggle between the three available choices.

### Audio Menu

The audio menu controls the sound of the internal and external speakers.

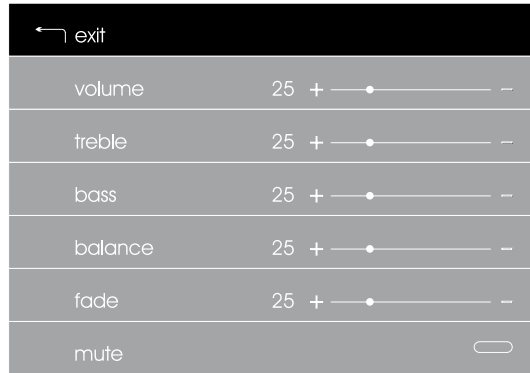

**FIGURE 10**

*Selections available within the audio menu*

#### Volume

The volume selection adjusts the volume of the internal and external speakers (if connected). Volume is increased when the slider is moved to the right.

#### Treble

The treble selection adjusts the treble tone, or high frequency, of the audio output. The treble setting applies to both internal and external speakers. Treble content increases when the slider is moved to the right.

#### Bass

The bass selection adjusts the bass tone, or low frequency, of the audio output. The bass setting applies to both internal and external speakers. Bass content is increased when the slider is moved to the right.

#### Balance

The balance selection controls the balance between the left and right internal and external speakers.

---

## Fade

The fade selection controls balance between the internal and external speakers. If no external speakers are connected, the selection will appear grayed out.

## Mute

Indicates whether mute is enabled (green light) or disabled (no light). Mute status is affected by reset or by removing power from the projector, but is not affected in the standby mode. Mute is active while in the freeze mode.

## Image Menu

The image menu controls the position, tracking and sync of the projected image. The menu will appear different if the source is video or from a computer input. The manual controls are only available when an analog computer is the active source and auto image is off. The manual controls are not available in the video mode since video is always set automatically.

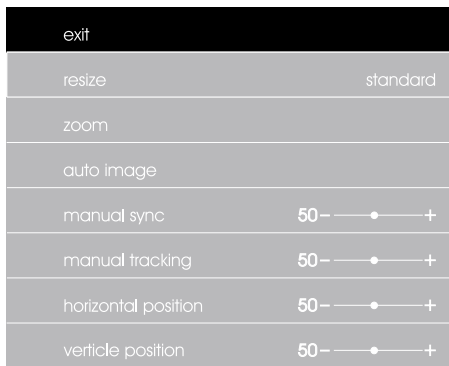

exit	
resize	standard
zoom	
auto image	
manual sync	50 - —●— +
manual tracking	50 - —●— +
horizontal position	50 - —●— +
verticle position	50 - —●— +

**FIGURE 11**

*Selections available within the image menu*

## Resize

Resize allows you to select from among four different re-sizing options, depending on your source. The default is **Standard**, which resizes the image from its original version to fit a standard 4x3 aspect ration screen. **Widescreen Letterbox** preserves the 16x9 aspect ratio of the original theater version. **Enhanced Widescreen** also preserves the aspect ratio and is designed to be used with content enhanced for Widescreen TVs. This option yields more detail than Widescreen Letterbox. **Native** displays the image with no resizing.

### **Zoom**

The zoom menu feature allows a selected area of the screen to be magnified. There is a dedicated zoom button on the remote for the zoom feature. The zoom button will initiate the zoom mode anytime it is pressed, except while in the menu mode. If the remote is not available, zoom can be initiated from the image menu, using the menu button on the projector keypad. The menu button will remain active while in the zoom mode. Zoom is cancelled if the source is changed, the signal lost, the projector placed in standby, or the projector is powered off.

Zoom mode consists of two parts, magnify and pan. Magnify is the part that allows closer viewing of a certain portion of the screen; pan is the part that determines what portion of the screen will be magnified. Magnify has a dedicated set of two buttons on the remote, magnify + and magnify -. Pan is controlled with the arrow buttons on the remote. Both the magnify buttons and the arrow buttons are always active in the zoom mode.

To cancel the zoom mode, press the zoom button on the remote or select it via the image menu on the projector keypad.

### **Auto Image**

The auto image selection is a toggle button that will turn the auto image ON or OFF. When auto image is ON, and the source is an analog computer, the system will automatically adjust the tracking and sync. When auto image is disabled, the best known mode will be applied to the signal and the user will have the option to adjust manual sync, manual tracking, horizontal and vertical position.

### **Video Standard (Video source only)**

The video standard selection allows the user to manually select among various video standards or to choose Automatic Video Standard Detection.

### **Overscan (Video source only)**

When a video source is selected, the overscan feature turns off the cropping of the video signal that is normally done for VCR inputs so that the full image can be seen with DVD.

### **Image Position**

When the resize mode is set to anything other than resize standard, the vertical position of the image can be changed. The three options are top, bottom, and center. Image position is grayed out when the resize mode is resize standard.

---

### **Manual Sync**

The manual sync selection adjusts the position of the sample within a pixel (picture element or dot) in the image. The start position and range are specific to the source and are determined by the auto image feature when the projector locks to a source; this is true even when auto image is turned off. When the auto image is on, the manual sync selection will appear grayed out. Auto image must be turned off to adjust the sync manually. The manual sync selection will also appear grayed out if the active source is video.

### **Manual Tracking**

Tracking is the number of samples per line. The start position and range are specific to the source and are determined by the auto image feature when the projector locks to a source; this is true even when auto image is off. When auto image is on, the manual sync selection will appear grayed out - Auto image must be turned off to adjust the sync manually. The manual sync selection will also appear grayed out if the active source is video.

### **Horizontal Position**

The horizontal position selection positions the projected image on the screen, side to side. The start position and range are specific to the source and are determined by the auto image feature when the projector locks to a source; this is true even when auto image is off. When auto image is on, the horizontal position will appear grayed out. Auto image must be turned off to adjust the position manually. The horizontal position selection will appear grayed out if the active source is video.

### **Vertical Position**

The vertical position selection sets the projected image on the screen, up and down. The start position and range are specific to the source and are determined by the auto image feature when the projector locks to a source; this is true even when auto image is off. When auto image is on, the vertical position selection will appear grayed out - Auto image must be turned off to adjust the position manually. The vertical position selection will also be grayed out if the active source is video.

### Control Menu

These controls are used primarily for the installation and setup and are not frequently used during normal operation.

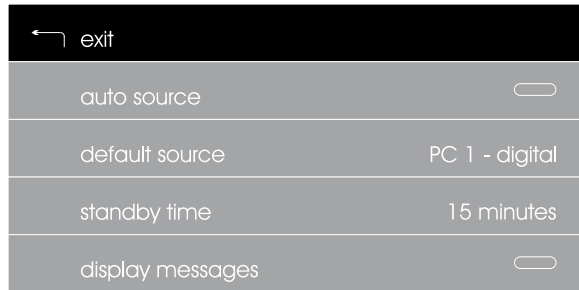

**FIGURE 12**

*Selections available within the Control Menu*

#### Auto Source

If auto source is OFF, the projector will stay on the default source (or current source if the user had changed sources).

If auto source is ON, the projector will search for a source until a signal is detected. When the signal is lost, the projector will again search for another signal, until a signal is again detected and then display that signal. If no signal is obtained, the screen will go blank.

#### Default Source

Sets the source the projector will first try to lock onto if auto source is ON. If auto source is OFF, the default source selection determines the only source the projector will look at.

#### Standby Time

The standby time selection allows the user to manually select the amount of time the unit will remain in standby before powering down.

#### Display Messages

The messages selection is a menu toggle that changes between ON and OFF. When the feature is on, a status message will appear in the lower right corner of the screen. Also a slider bar will appear in the lower right of the screen if keystone or volume is adjusted from either the projector keypad or remote. The message will remain on for five seconds after it is initiated.

---

## Advanced Menu

The advanced menu is an array of miscellaneous controls. Most of these controls are used primarily for installation and setup and are not frequently accessed during operation.

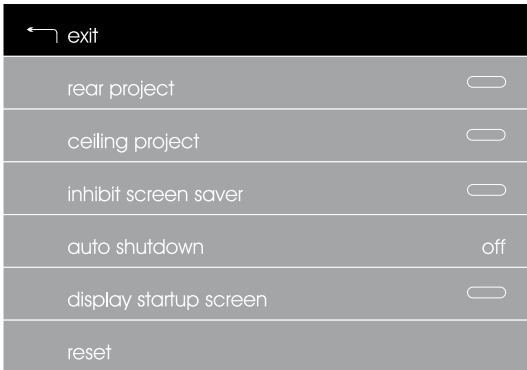

**FIGURE 13**

*Selections available within the Advanced Menu*

### Rear Project

When you turn rear project on, the projector reverses the image so you can project from behind a translucent screen. Highlight rear project and then use the left or right mouse button on the to toggle this feature ON or OFF.

### Ceiling Project

When you turn ceiling project on, the projector turns the image upside down for ceiling-mounted projection. Highlight ceiling project, then use the left or right mouse button on the remote to toggle this feature ON or OFF.

### Inhibit Screen Saver

You can control the functionality of your screen saver selection, between ON and OFF. This feature prevents the computers screen saver from interrupting presentations.

### Auto Shutdown

The auto shutdown time selection allows the user to manually select the amount of time the projector will remain on with no signal detected, before powering down. Selecting the OFF option will disable this feature.



**CAUTION:** *When the projector is ceiling mounted, you must affix the Caution Label (included in the document packet) to the lamp door.*

### Display Startup Screen

The display startup screen determines whether the default screen is the standard InFocus screen or a blank screen.

### Reset

The reset selection resets many of the controls to their default settings. Items which will not be reset include language, ceiling projection, standby time, auto shutdown time, rear projection, and keystone.

### Language Menu

This menu allows the user to select a specific language that all other menus and text will appear.



**FIGURE 14**

*Selections available within the Language Menu*

---

## Status Menu

This is a read-only window for information purposes.

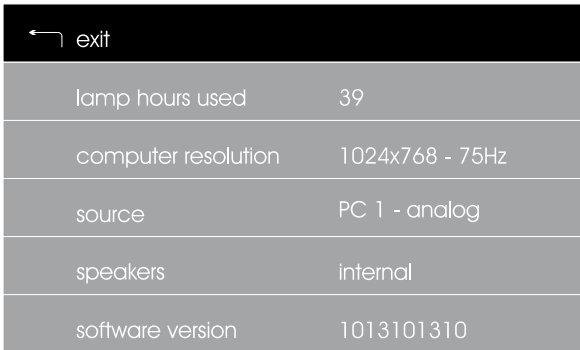

← exit	
lamp hours used	39
computer resolution	1024x768 - 75Hz
source	PC 1 - analog
speakers	internal
software version	1013101310

**FIGURE 15**

*Selections available within the Status Menu*

### Lamp Hours Used

Indicates how many hours the current lamp has been in use. The counter starts at zero hours and counts each hour the lamp is in use. Change the lamp when the brightness is on longer acceptable. See Replacing the Projection Lamp on page 37.

### Computer Resolution

Shows your computer's resolution settings. To change this, go to your computer's control panel and adjust the resolution in the display tab. See your computer's user's guide for details.

### Source

Indicates the current, active source of the signal being provided to the projector.

### Speakers

Indicates whether the projector is using internal, external, or no speaker source.

### Software Version

Indicates the current version of software installed on the projector.