

# IN 1500 (SERIES)

**InFocus**  
Bright Ideas Made Brilliant

## Up Close, Anywhere

Short Throw, Bright, Connected, Compact



# IN1500 (SERIES)

## Redefine mobile projection.

The IN1500 series combines powerful close-up projection with a compact form factor, making it an ideal solution for collaborative environments where space is a luxury. The short throw lens allows for edge-of-table projection, cutting throw distances for maximum image sizes. Loaded with the InFocus plug and project suite of digital connections, including DisplayLink™, HDMI 1.3, and LitePort™ PC-free presenter, the IN1500 series is the most digitally capable mobile projector line-up on the market. Lightweight, portable, and powerful, the IN1500 series boast a maximum brightness of 3000 lumens with native resolution up to WXGA. The IN1500 series brings leading-edge projection to the tightest of spaces.



### IN 1501

XGA (1024 x 768) DLP®  
The InFocus IN1501 brings a rich suite of digital connectivity and big pictures to tight spaces.

### IN 1503

WXGA (1280 x 800) DLP  
The InFocus IN1503 brings a wider viewing range and brilliant InFocus picture quality to the smallest rooms.

### Rich Connectivity

The IN1500 series is packed with leading edge digital connectivity such as HDMI 1.3 for seamless compatibility with the latest computer and HD Video sources, along with InFocus custom connections such as DisplayLink and LitePort inputs for plug-and-project ease. The IN1500 series also features standard analog connectivity including VGA (HD15) and composite video.

### High Brightness

With a maximum brightness of 3000 lumens, the IN1500 series is bright enough for lights-on projection in any small to medium collaborative environment.

### Close-up Projection

The IN1500 series offers edge-of-table projection, making it ideal for small to medium meeting rooms. The short throw translates into more table space and less ambient noise during conference calls and meetings.



*Short throw flexibility, sleek compact form factor and full digital connectivity. The IN1500 series has everything I've always wanted designed into a meeting room projector line-up.*

Loren Shaw  
InFocus Product Director

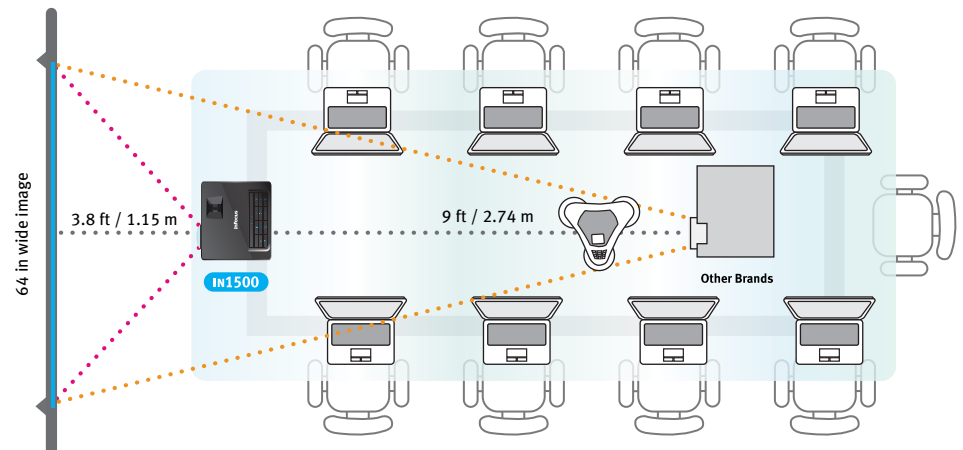

### Optical Zoom

A 20% zoom gives the IN1500 series maximum flexibility to resize the screen without moving the projector.

### LiteSwitch

The InFocus LiteSwitch instant ON/OFF feature cuts “cooldown” time and allows for faster transitions between meetings, enabling you to start up and shut down your projector in seconds. No more waiting. Just highly productive meetings with no time wasted in between.

### 24/7 Non-Stop Projection

All new InFocus DLP projectors are filter-free and are rated for 24/7 fail-safe operation, resulting in less maintenance and hours of worry-free use.

### PC-Free Presentations

The IN1503 features LitePort, an embedded PC-free JPEG Reader that enables users to project images directly from a standard USB flash drive – no computer needed.

### LiteTouch™ Keypad

The sleek backlit LiteTouch control panel provides one-touch access to the most commonly used projector functions.



### Intuitive and Easy to Use Interface

Over 20 years of customer feedback has gone into designing the IN1500 series best-in-class menu system. It is easy to navigate, has 17 standard languages and a unique intuitive flow.

### Install Flexibility

Maximum flexibility for the smallest rooms. The IN1500 series can be ceiling-mounted in rooms where space is a luxury.

### DisplayLink Connectivity

Hassle-free, lightning fast-projection. Wired and Wireless DisplayLink Content over USB technology eliminates the need for bulky VGA cables and allows for computer and image set up in seconds. Optional Wireless DisplayLink adapters provide secure point-to-point transmissions up to 99mbps. No toggling or cumbersome function key combinations. DisplayLink makes projecting simple!

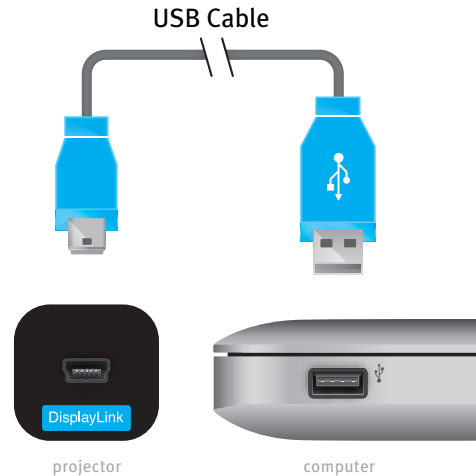

### Digital, Brilliant Color

The IN1500 series delivers superior visual performance with DLP Technology, finely tuned with our own BrilliantColor™ enhancement, for vibrant, true to life images in vivid detail.

### Wide Resolution

The IN1503, with WXGA (1280 x 800) native resolution, offers substantially wider space to display high resolution images for the next generation of operating systems and full high definition 1080p video.



XGA  
1,024 x 768 PIXELS

WXGA  
1,280 x 800 PIXELS

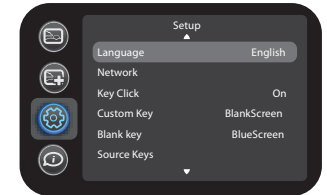

InFocus short throw lens

Edge-of-table projection

### Optional Accessories

Wireless Displaylink (SP-DOUSB-WIRELESS)  
 Replacement Lamp IN1501 (SP-LAMP-059)  
 Replacement Lamp IN1503 (SP-LAMP-052)  
 Universal Ceiling Mount (SP-CEIL-UNIV)  
 Wall Arm Mount (SP-WALL-ARM)  
 Projector Screens  
 Cables & Adaptors

For more information, please visit:  
[www.infocus.com/Accessories.aspx](http://www.infocus.com/Accessories.aspx)

### InFocus Promise

Providing the highest quality products and support is very important to InFocus. The IN1500 series of digital projectors come standard with a 5 year limited factory warranty (including parts<sup>1</sup> and labor<sup>2</sup>) a 6 month limited lamp replacement warranty and 5 year DLP warranty. Extended product and lamp warranty programs are also available.

For more information, please visit:  
[www.infocus.com/Support/Warranty.aspx](http://www.infocus.com/Support/Warranty.aspx)

### IN1500 (SERIES) FEATURES

- Auto Keystone ○
- BrilliantColor ○
- Closed Captioning ○
- DisplayLink Plug & Play ○
- Freeze Frame with Magnifying Function ○
- HDMI 1.3 ○
- InFocus User Interface ○
- LitePort USB JPEG Player - IN1503 ○
- LiteSwitch On/Off ○
- LiteTouch Touchsense Keypad ○
- Logo Capture ○
- Low Power Standby (<1W) ○
- Optical Zoom ○



**InFocus**  
 Bright Ideas Made Brilliant

[www.infocus.com](http://www.infocus.com)

**INFOCUS CORPORATE HEADQUARTERS**  
 13190 SW 68th Parkway  
 Portland, Oregon 97223-8368, USA  
 Phone: (1) 503-207-4700  
 Toll Free: (1) 877-388-8385  
 Fax: (1) 503-207-1937

**INTERNATIONAL HEADQUARTERS**  
 4 Teck Lim Road  
 Singapore 088382  
 Phone: (65) 6513-9600  
 Fax: (65) 6238-0535

# Specifications\*

**IN1501** **IN1503**

Native Resolution	<b>IN1501</b> – XGA 1024 × 768 <b>IN1503</b> – WXGA 1280 × 800
Maximum Resolution	UXGA (1600 × 1200)
Display Technology - DMD	<b>IN1501</b> – DLP .55" XGA <b>IN1503</b> – DLP .65" WXGA
Brightness	3000 ANSI lm, (2300 lm Eco Mode)
Lamp Life**	4000 Hrs Eco Mode (3000 Hrs Normal)
Contrast Ratio	1800:1 Typical
Audible Noise	29 db Eco Mode (33 db High Power)
Computer Compatibility	PC, MAC
Keystone Correction	Automatic, Vertical -30/+30 degrees)
Number of Colors	16.7 Million, True Color
Aspect Ratio	<b>IN1501</b> – Native 4:3 (16:9, 16:10 Supported) <b>IN1503</b> – Native 16:10 (4:3, 16:9 Supported)
Lamp Power	170w Eco Mode (225w Normal)
Power Supply	100 ~ 240 VA, 50 ~ 60 Hz
Zoom Ratio	1.2:1
Throw Ratio	<b>IN1501</b> – 0.89 ~ 1.07 <b>IN1503</b> – 0.72 ~ 0.86
Video Compatibility	NTSC / PAL / SECAM SDTV: 480i, 576i EDTV: 480p, 576p HDTV: 720p, 1080i, 1080p
Audio	1W mono
Input Sources	<b>IN1501</b> – HD15 × 1, Composite (RCA) × 1, HDMI 1.3 × 1 Audio 3.5 mm × 1, DisplayLink <b>IN1503</b> – HD15 × 1, Composite (RCA) × 1, HDMI 1.3 × 1 Audio 3.5 mm × 1, DisplayLink, LitePort
Projection Distance	2.5 ft ~ 11.5 ft / 0.75 m ~ 3.5 m
Projection Methods	Front, Rear, Ceiling
Product Weight	4.4 lb / 2.0 kg
Product Dimensions - W×D×H	9.25 × 8.74 × 3.29 in / 235 × 222 × 83.8 mm
Product Color	Black and Silver
Shipping Dimension - W×D×H	8.98, 16.14, 15.63 in / 228 × 409 × 397 mm
Shipping Weight	9.48 lb / 4.3 kg
Maximum Altitude	10,000 ft / 3,000 m
Remote Control	Navigator - 3
Ships With - Accessories	Remote, Power Cord (3 m), USB A to mini B cable (2 m), Thin VGA Cable (2 m), Case with Cable Management, Safety Instruction, Projector User's Guide, DisplayLink User's Guide
Menu Languages	English, French, German, Italian, Korean, Portuguese, Russian, Spanish, Traditional Chinese, Simplified Chinese, Swedish, Finnish, Danish, Dutch, Polish, Turkish, Norsk
Lamp Rupture Containment	Tested to larger than 0.8 mm ***
Accessories Warranty	90 days
Approvals	C-Tick (Australia), NOM (Mexico), CE (Europe), UL & CUL (USA & Canada), FCC (USA), IRAM (Argentina), GOST (Russia), CCC (China), PSB (Singapore), WEEE (EU), S. Africa, MIC & eK (South Korea), RoHS, China RoHS
Security	Kensington Lock



©2011 InFocus Corporation. All rights reserved. Specifications are subject to change without further notice. InFocus and InFocus Bright Ideas Made Brilliant are either trademarks or registered trademarks of InFocus Corporation in the United States and other countries. DLP, the DLP logo, and the DLP medallion are trademarks of Texas Instruments. All trademarks are used with permission or are for identification purposes only and are the property of their respective companies.  
<sup>1</sup>Excludes power supply, fans, color wheel and light tunnel which are covered for two (2) years.  
<sup>2</sup>Labor is covered for two (2) years from date of proof of purchase.  
 InFocus\_IN1500\_DS\_EN\_20Feb11. Part Number: MMINFOCUS-0204

\* Product specifications, terms, and offerings are subject to change at any time without notice.  
 \*\* Actual lamp life may vary based on the ambient environment and projector usage. Conditions that may affect lamp life include temperature, altitude, and rapidly switching the projector on and off.  
 \*\*\* Tested to contain particles larger than the specified size in any dimension