

# IN5500 (SERIES)

**InFocus**  
Bright Ideas Made Brilliant

## Simply Stunning

Ease of Use - Sophisticated Features  
Elegant Styling - Stunning Image Quality

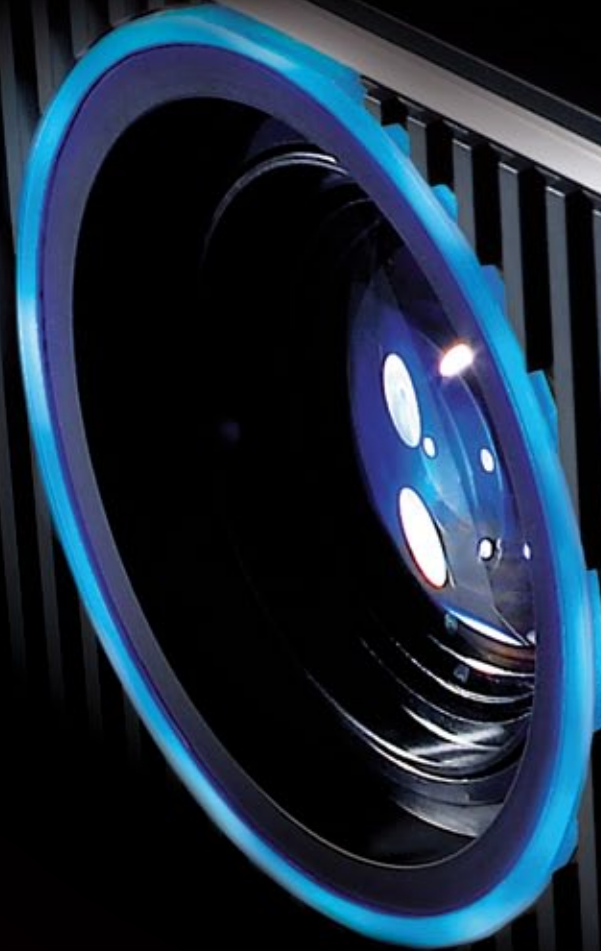

# IN5500 (SERIES)

## Outshine the brightest

Offering best-in-class performance and a wealth of features, the IN5500 series projectors use DLP® DarkChip™3 technology and InFocus award-winning BrilliantColor™ implementation, and offer up to WUXGA (1920 × 1200) resolution. These projectors are ideal for demanding professional applications requiring flexible lens options. With rich connectivity and embedded networking, the IN5500 series also features a filter-free design for fail-safe 24/7 operation. Customizable skins and an integrated cable management give the IN5500 series a sleek, elegant profile to complement any venue. And with a high brightness of up to 7000 lumens, any audience will sit up and take notice.



### IN5502

WXGA (1280 × 800) DLP DARKCHIP3  
SINGLE 330 W LAMP  
Ideal WXGA integration projector.

### IN5532

WXGA (1280 × 800) DLP DARKCHIP3  
DUAL 330 W LAMP, LIQUID COOLED DMD  
For installations requiring fail-safe  
24/7 operations.

### Custom Skins

Choose your cover. With options in Matte Black, Matte White, Glossy Black, Walnut, or pre-primed custom skins, the IN5500 series blends beautifully with any décor.

### Digital, Brilliant Color

The IN5500 series delivers a stunning combination of HD resolution and vivid detail in true-to-life colors with the latest DLP DarkChip3 technology and InFocus award-winning BrilliantColor implementation. For lasting brightness and color that stays.

### IN5504

WUXGA (1920 × 1200) DLP DARKCHIP3  
SINGLE 330W LAMP  
HD flexibility at its finest.

### IN5534

WUXGA (1920 × 1200) DLP DARKCHIP3  
DUAL 330W LAMP, LIQUID COOLED DMD  
Dual lamps and a full range  
of lens options.



### High Resolution WXGA/WUXGA

With WXGA (1280 × 800) and WUXGA (1920 × 1200) native resolutions, the IN5500 series offers substantially wider space to display high resolution images for the next generation of operating systems and full high definition 1080p video.



**WXGA**  
1,280 x 800 PIXELS

**WUXGA**  
1,920 x 1,200 PIXELS



*“We are at the forefront of the Installation Category with best in class performance and the latest in DLP and Lamp Technology.”*

**Benjamin Joy**  
InFocus Product Director

### Rich Connectivity

The IN5500 series features full analog connectivity with HD15, BNC and component inputs, and HDMI 1.3 for the latest in Computer and HD Video connectivity. Engineered to be Wireless-Ready with LiteShow III™, the IN5500 series also includes embedded networking and RS232 control for full projector management.

### Unique “Blue Iris” Glow Ring

The exclusive InFocus “Blue Iris” glow ring notifies users - from experienced to novice - when the projector is powering up or down. No more guessing the status of the projectors.

### Single or Dual Lamps

The IN5500 series is available in single lamp for energy efficiency and low cost of ownership, or dual lamps for high brightness and fail-safe back-up protection.

### LiteShow III

Connect the InFocus LiteShow III wireless adaptor to any projector or other display to quickly and easily share data, audio and video over a secure wireless connection. Plus, its Moderator and Quadview features make it easier to collaborate by allowing multiple computers to connect to the display simultaneously.

### 24/7 Non-Stop Projection

All new InFocus DLP projectors are filter-free and are rated for 24/7 fail-safe operation, resulting in less maintenance and hours of worry-free use.

### LiteTouch™ Keypad

The sleek backlit LiteTouch control panel provides one-touch access to the most commonly used projector functions.



### High Performance Optics

Built-in horizontal and vertical lens shift allows mechanical alignment without optical distortion to retrofit legacy installations. Automatic sensors for ceiling detection and keystone means you will have a crisp, square image everytime. Pincushion and Barrel Distortion is eliminated, enabling the IN5500 series to project perfect images even on imperfect surfaces.

### Projector Management

Control at your fingertips. The IN5500 series built-in web browser allows network administrators to remotely access and control the projector over standard LAN/WAN. The series is compatible with ProjectorNet™ 3.0, our free asset management software that enables you to conserve projector lamp life by scheduling On/Off times, and presetting maintenance events and anti-theft security alerts.

### Dynamic Messaging System

Send dynamic messages for instant display to InFocus projectors using the InFocus Dynamic Messaging System (DMS). Perfect for general and important announcements such as schedule changes, weather warnings, breaking news and emergency notifications.

### Horizontal and Vertical Lens Shift

Motorized lens shift  
- vertical -50% to +10%, horizontal +/-10%

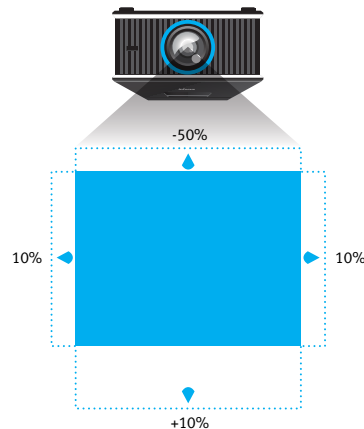

### Intuitive and Easy to Use Interface

Over 20 years of customer feedback has gone into designing the IN5500 series best-in-class menu system. It is easy to navigate, has 17 standard languages and a unique intuitive flow.

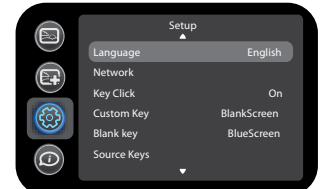

### Unique Cable Management System

The integrated cable management system provides easy access to the rich connector panel, while aligning each cable to the cable router. The result: 100% hidden cables that look as good as the rest of your room.



### SplitScreen™

Project images from 2 sources simultaneously and in a variety of configurations with with InFocus SplitScreen technology. Perfect for viewing multiple presentations, videoconferencing and distance learning.



Unique Cable Management System

InFocus Optics Laboratory

## Optional Accessories

Projection Screens  
Cables & Adaptors  
Security Lock (SEC-LOCK-01)  
Replacement Lamp IN5502/04 (SP-LAMP-055)  
Replacement Lamps IN5532/34 (SP-LAMP-055 and SP-LAMP-056)  
LiteShow III Wireless Adapter (INLITESHOW3)  
Ceiling Mount (SP-CEIL-INSTALL)  
Commander Remote (HW-COMMANDER-2)  
Short Throw Fixed Lens (LENS-050)  
Short Throw Zoom Lens (LENS-051)  
Long Throw Zoom Lens (LENS-052)  
Ultra Long Throw Zoom Lens (LENS-053)  
Glossy Black Skin Kit (TOP-05-GB)  
Matte White Skin Kit (TOP-05-MW)  
Walnut Skin Kit (TOP-05-W)  
Primer Skin Kit (TOP-05-B)

For more information, please visit:  
[www.infocus.com/Accessories.aspx](http://www.infocus.com/Accessories.aspx)

## DisplayLink

Hassle-free, lightning fast-projection. DisplayLink Content over USB technology eliminates the need for bulky VGA cables and allows for computer and image set up in seconds without toggling or cumbersome function key combinations. DisplayLink makes projecting simple!

## Warranty

Providing the highest quality products and support is very important to InFocus. The new IN5500 series digital projectors come standard with a 5 year limited factory warranty (including parts<sup>1</sup> and labor<sup>2</sup>) a 6 month limited lamp replacement warranty and 5 year DLP warranty. Extended product and lamp warranty programs are also available.

For more information, please visit:  
[www.infocus.com/Support/Warranty.aspx](http://www.infocus.com/Support/Warranty.aspx)

## Interchangeable Lenses

Interchangeable lenses provide greater flexibility for a large variety of applications – from short throw to ultra long throw projection.



Navigator - 3 Remote

## IN5500<sup>(SERIES)</sup> FEATURES

- 2-3 Pull Down
- Auto Keystone
- BrilliantColor
- Cable Management System
- Centered Lens
- Closed Captioning
- Custom Skins
- DisplayLink Plug & Play (DDC2B)
- DMS Dynamic Messaging System
- Electrical H&V Keystone Correction
- Freeze Frame with Magnifying Function
- InFocus UI
- LitePort USB JPEG Player
- LiteShow III Wireless Ready
- LiteTouch Touchsense Keypad
- Logo Capture
- Low Power Standby (<1W)
- Motorized Focus and Zoom
- Motorized Lens Shift
- Pincushion/Barrel Distortion Correction
- ProjectorNet Web Browser Control
- Sleep Timer
- SNMP Capable
- SplitScreen Dual Images
- Top Lamp Access



# InFocus

Bright Ideas Made Brilliant

[www.infocus.com](http://www.infocus.com)

**INFOCUS CORPORATE HEADQUARTERS**  
13190 SW 68th Parkway  
Portland, Oregon 97223-8368, USA  
Phone: (1) 503-207-4700  
Toll Free: (1) 877-388-8385  
Fax: (1) 503-207-1937

**INTERNATIONAL HEADQUARTERS**  
4 Teck Lim Road  
Singapore 088382  
Phone: (65) 6513-9600  
Fax: (65) 6238-0535



©2011 InFocus Corporation. All rights reserved. Specifications are subject to change without further notice. InFocus and InFocus Bright Ideas Made Brilliant are either trademarks or registered trademarks of InFocus Corporation in the United States and other countries. DLP, the DLP logo, and the DLP medallion are trademarks of Texas Instruments. All trademarks are used with permission or are for identification purposes only and are the property of their respective companies.  
<sup>1</sup>Excludes power supply, fans, color wheel and light tunnel which are covered for two (2) years.  
<sup>2</sup>Labor is covered for two (2) years from date of proof of purchase.  
InFocus\_IN5500\_DS\_EN\_15MAR11. Part Number: MMINFOCUS-0204

# Specifications\*

	IN5502	IN5532	IN5504	IN5534
Native Resolution	IN5502 & IN5532 – WXGA 1280 × 800 IN5504 & IN5534 – WUXGA 1920 × 1200			
Maximum Resolution	WUXGA (1920 x 1200)			
Display Technology - DMD	IN5502 & IN5532 – DLP .65" WXGA, DarkChip3 IN5504 & IN5534 – DLP .67" WUXGA, DarkChip3			
Brightness	IN5502 & IN5504 – 5000 ANSI lm, (4,000 lm Eco Mode) IN5532 & IN5534 – 7000 ANSI lm, (5,500 lm Eco Mode)			
Lamp Life**	2000 Hrs Eco Mode (1500 Hrs Normal)			
Contrast Ratio	2000:1 Typical			
Audible Noise	29 db Eco Mode (30 db High Power)			
Computer Compatibility	PC, MAC			
Lenses	IN5502 & IN5532		IN5504 & IN5534	
Standard (inc)	Throw Ratio	Zoom Ratio	Throw Ratio	Zoom Ratio
Fixed (LENS-050)	1.52 – 2.03	1.33×	1.45 – 1.93	1.33×
Wide Zoom (LENS-051)	0.81		0.77	
Long Zoom (LENS-052)	1.27 – 1.52	1.2×	1.21 – 1.45	1.2×
Ultra Long (LENS-053)	2.03 – 3.85	1.9×	1.93 – 3.67	1.9×
Lens Shift Type	3.85 – 7.32	1.9×	3.67 – 6.97	1.9×
Lens Shift	Motorized			
- Vertical	-50% to +10%			
- Horizontal	+/- 10%			
Colorwheel	RGBYW / 5 Segment			
Number of Colors	1.07 Billion			
Aspect Ratio	Native 16:10 (4:3, 5:4, 16:9 Supported)			
Lamp Power	IN5502 & IN5504 – 330 W lamp × 1 IN5532 & IN5534 – 330 W lamp × 1			
Zoom/Focus	Power Zoom, Power Focus			
Synch - Horizontal Scan Freq	15 – 100 kHz (Video/PC)			
- Vertical Scan Freq	50 – 85 Hz (Video/PC)			
Video Compatibility	NTSC / PAL / SECAM / PAL-M, N / NTSC4.43 SDTV: 480i, 480p, 576i, 576p HDTV: 720p, 1080i, 1080p (60,30,24Hz)			
Audio	5 W × 2			
Input Sources	15pin Dsub × 2, 5 BNC, DisplayLink, LitePort, HDMI 1.3 × 2, Component × 1, S-Video × 1, Composite × 1, Stereo Mini × 2, RCA Stereo × 3			
Output Sources	15pin Dsub × 1 Stereo-Mini Jack × 1			
Control	2.5 mm Stereo Mini, Projector Keypad, IR Remote Control, USB, RS232, RJ45, Wired Remote			
Screen Trigger	3.5 mm Mini 12VDC 250 ma			
Network	10 BASE-T, 100 BASE-TX			
Product Weight	44.1 lbs / 20.0 kg			
Product Dimensions - W×D×H	17.0 × 26.38 × 9.45 in / 432 × 670 × 240 mm			
Product Color	Matte Black, Glossy Black, Matte White, Walnut, Primer for Customization			
Shipping Dimension - W×D×H	39.0 × 23.4 × 13.0 in / 991 × 594 × 330 mm			
Shipping Weight	57.5 lbs / 26.0 kg			
Maximum Altitude	7,500 ft / 2286 m			
Remote Control	Navigator - 3			
Ships With - Accessories	RGB Cable, Power Cord, USB Mini-B to A, Remote, Safety Instruction, Projector User's Guide, Display Link User's Guide			
Menu Languages	English, French, German, Italian, Korean, Portuguese, Russian, Spanish, Traditional Chinese, Simplified Chinese, Norwegian, Swedish, Finnish, Danish, Dutch, Polish, Turkish			
Lamp Rupture Containment	Tested to larger than 0.8 mm ***			
Accessories Warranty	90 days			
Regulatory Models	F5500 (IN5502, IN5504); F5530 (IN5532, IN5534)			
Approvals	UL60950-1/cUL (USA and Canada), FCC Part 15, Class A (USA), CE (Europe), NOM (Mexico), S-Mark (Argentina), GOST (Russia), KC (Korea), SAFETY Mark (Singapore), CCC, CECP (China), C-Tick (Australia/NZ)			
Security	Kensington Lock			

\* Product specifications, terms, and offerings are subject to change at any time without notice.  
\*\* Actual lamp life may vary based on the ambient environment and projector usage. Conditions that may affect lamp life include temperature, altitude, and rapidly switching the projector on and off.  
\*\*\* Tested to contain particles larger than the specified size in any dimension.