

SP8602

InFocus
Bright Ideas Made Brilliant



Next Generation Home Cinema

Ease of Use - Sophisticated Features
Elegant Styling - Stunning Image Quality

SP8602

Introducing the next generation of ScreenPlay Home Cinema

The InFocus ScreenPlay 8602 combines rich styling, stunning imagery, full features, and connectivity into an award-winning HD home cinema projector that creates a truly immersive cinema experience. It features DLP® DarkChip™ technology with cutting edge InFocus BrilliantColor™ implementation and native 1080P resolution. The SP8602 offers 30,000:1 contrast ratio, high-performance optics, and the latest in high-definition connectivity to display high-resolution images and video content in vivid colours with outstanding depth and detail. With the InFocus SP8602, you will never miss a thing.

It's all in the details

Even the most minute detail yields maximum impact. The InFocus SP8602 features DLP DarkChip technology with InFocus BrilliantColor implementation and video-optimized 1300 lumens for stunning clarity, colour, and vibrancy, recreating true cinematic experience in high definition 1080P resolution with astounding realism. Discover the thrill of larger-than-life home entertainment with a system that raises your adrenaline and makes you a player in the game.

Real blacks, amazingly bright colours

The SP8602 delivers the deepest blacks and brightest, most vibrant colours even with the lights on. DynamicBlack™ and the latest DarkChip Technology deliver 30,000:1 maximum contrast, distinguishing varying shades of blacks with razor-sharp accuracy while giving the same intuitive discrimination in displaying colourful images. Digital Gamma correction and Variable Colour adjustment uses a range of 1.07 billion colours and a 6-segment colour wheel—capturing life's diverse hues and textures, and projecting them into your home.

Ultra-smooth playback

Using Pixelworks DNX™ 10-bit video processing, the SP8602's outstanding processing, de-interlacing, and advanced scaling delivers ultra-smooth playback of film and video content including 24 frame per sec support (1080P/24). It uses a proprietary 120 Hz motion engine that allows for faster, more fluid transition between frames in moving images. The result is elimination of film judder and reduced blur caused by recording device response time with fast motion compensated frame interpolation. Fast colour refresh provides colour stability and superb motion quality, further enhancing the viewing experience.

Get the best seat in the house

The SP8602 features vertical and horizontal lens shifts that can beam an image of up to 750 cms from anywhere in the room and still project a perfect picture onscreen. Automatic ceiling detection will flip the image when necessary, and image warping allows for adjusting images on imperfect surfaces, giving you crisp, square images every time.

"The InFocus ScreenPlay 8602 is a blockbuster hit blending rich styling, full features and stunning image quality into an award winning home cinema HD projector".

Benjamin Joy
InFocus Product Director



Choose Your Colour

The SP8602's outer design offers you the option of interchangeable skins to match your décor. Choose from Matte Black, Matte White, Glossy Black, Walnut, or even a pre-primed set for custom installations.

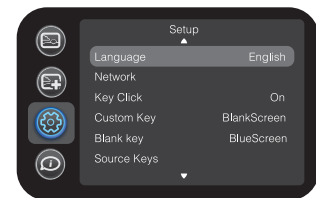

Digital, Brilliant Colour

The SP8602 delivers a stunning combination of HD resolution and vivid detail in true-to-life colours using DLP DarkChip technology with the InFocus BrilliantColor enhancement. For lasting brightness and colour that stays.

Rich Connectivity Flexibility

The SP8602 uses the latest in high-definition connectivity, providing a complete suite of analog and digital connectivity, including an onboard HDMI 1.3 DeepColor support for the ultimate in installation flexibility.

Unique “Blue Iris” Glow Ring

The exclusive InFocus “Blue Iris” glow ring notifies users – from experienced to novice, when the projector is powering up or down. No more guessing the status of the projector.

Intuitive and Easy to Use Interface

Over 20 years of customer feedback has gone into designing the SP8602 best-in-class menu system. It is easy to navigate, has 17 standard languages and a unique intuitive flow.

Unique Cable Management System

The integrated cable management system provides easy access to the rich connector panel, aligning each cable to the cable router, keeping them organized and out of sight. The result: 100% hidden cables that look as good as the rest of your room.

LiteTouch™ Keypad

The sleek backlit LiteTouch control panel provides one-touch access to the most commonly used projector functions.



InFocus LiteTouch Keypad



Optional Accessories

Cables & Adaptors
Security Lock (SEC-LOCK-01)
Replacement Lamp (SP-LAMP-054)
Ceiling Mount (SP-CEIL-INSTALL)
Glossy Black Skin Kit (TOP-03-GB)
Matte White Skin Kit (TOP-03-MW)
Walnut Skin Kit (TOP-03-W)
Primer Skin Kit (TOP-03-B)

For more information, please visit:
www.infocus.com/Accessories.aspx



Warranty

Providing the highest quality products and support is very important to InFocus. The SP8602 digital projector comes standard with a 5 year limited factory warranty (including parts¹ and labour²), a 1 year limited lamp replacement warranty and 5 year DLP warranty.

For more information, please visit:
www.infocus.com/Support/Warranty.aspx



DIRECTOR - 2 Remote

SP8602 FEATURES

- 4x/6x Colour Refresh Rate
- 2-3 Pull Down
- BrilliantColor
- Cable Management System
- Ceiling Mount
- Custom Skins
- Digital Gamma Correction
- Electrical H&V Keystone Correction
- Flesh Tone Correction
- Freeze Frame with Magnifying Function
- Full 2.35 Cinemascope Support
- InFocus UI
- ISF Presets
- Lamp Door on Side
- Low Power Standby (<1W)
- LiteTouch Touchsense Keypad
- Motion Smoothing
- Pincushion/Barrel Distortion Correction
- Sleep Timer
- SplitScreen™ Dual Images



InFocus

Bright Ideas Made Brilliant

www.infocus.com

INFOCUS CORPORATE HEADQUARTERS
13190 SW 68th Parkway
Portland, Oregon 97223-8368, USA
Phone: (1) 503-207-4700
Toll Free: (1) 877-388-8385
Fax: (1) 503-207-1937

INTERNATIONAL HEADQUARTERS
1 Fullerton Road
One Fullerton
Singapore 049213
Phone: (65) 6513-9600
Fax: (65) 6238-0535

©2009 InFocus Corporation. All rights reserved. Specifications are subject to change without further notice. InFocus and InFocus Bright Ideas Made Brilliant are either trademarks or registered trademarks of InFocus Corporation in the United States and other countries. DLP, the DLP logo, and the DLP medallion are trademarks of Texas Instruments. All trademarks are used with permission or are for identification purposes only and are the property of their respective companies.
¹Excludes power supply, fans, colour wheel and light tunnel which are covered for three (3) years.
²Labour is covered for three (3) years from date of proof of purchase.
InFocus_SP8602_DS_EU_10|AN10. Part Number: MMINFOCUS-0204

Specifications*

SP8602

| | |
|-----------------------------------|---|
| Native Resolution | 1920 × 1080 (1080P) |
| Maximum Resolution | WUXGA (1920 × 1200) |
| Display Technology - DMD | DLP .65" 1080p DarkChip w/BrilliantColor |
| Brightness | 1300 Video Lumens (Optimized for REC 709 Video) |
| Lamp Life** | 2500 Hrs Eco Mode (2000 Hrs Normal) |
| Contrast Ratio - Full On/Full Off | 5000:1 Native |
| ANSI Contrast Ratio | 500:1 |
| Contrast Ratio DynamicBlack | 30,000:1 Max |
| Audible Noise | 28 db Eco Mode (29 db High Power) |
| Computer Compatibility | PC, MAC |
| Lenses (Std) - Focal Length | 22.18 mm at f2.45 ~ 33.27 mm at f2.9 |
| - Throw Ratio | 1.494 ~ 2.279 |
| - Zoom Ratio | 1.5 |
| - Focus Range | 1.5m ~ 9.1 m |
| Lens Shift Type | Manual |
| Lens Shift - Vertical | +5% to +30% |
| - Horizontal | +/- 15% at 105% Vertical Offset |
| Colourwheel | RGBRGB / 6 Segment |
| Number of Colours | 10 Bit/Colour 1.07 Billion Colours |
| Aspect Ratio | Native 16:9 (5:4, 4:3, 16:10 Supported) |
| Lamp Power | 260 Watt |
| Zoom/Focus | Manual Focus Manual Zoom |
| Synch - Horizontal Scan Freq | 15 ~ 100 kHz (Video/PC) |
| - Vertical Scan Freq | 50 ~ 85 Hz (Video/PC) |
| Video Compatibility | NTSC / PAL / SECAM / PAL-M, N / NTSC4.43 SDTV: 480i, 480p, 576i, 576p HDTV: 720p, 1080i, 1080p (60,30,24 Hz) |
| Input Sources | 15pin Dsub (VGA), HDMI 1.3 DeepColor Support × 2, Component × 3, S-Video, Composite |
| Control | RS232 Dsub-9, USB Type B |
| Screen Trigger | 3.5 mm Mini × 3, 12VDC 250ma |
| Wired IR | 3.5 mm Stereo Mini Following Xantech Standard |
| Product Weight | 16.76 lbs / 7.6 kg |
| Product Dimensions - WxDxH | 14.25 × 21.25 × 7.0 in / 362 × 540 × 178 mm |
| Product Colour Options | Matte Black, Glossy Black, Matte White, Walnut, Primer for Customisation |
| Shipping Dimension - WxDxH | 27.5 × 19.5 × 12.32 in / 699 × 495 × 313 mm |
| Shipping Weight | 28.3 lbs / 12.8 kg |
| Maximum Altitude | 7,500 ft / 2286 m |
| Remote Control | Director - 2 |
| Design | InFocus 2009 ID |
| Ships with - Accessories | HDMI Cable (2.5 m), Power Cord (2.5 m), Remote, Projector User's Guide |
| Menu Languages | English, French, German, Italian, Korean, Portuguese, Russian, Spanish, Traditional Chinese, Simplified Chinese, Norwegian, Swedish, Finnish, Danish, Dutch, Polish, Turkish |
| Lamp Rupture Containment | Tested to larger than 0.8 mm *** |
| Accessories Warranty | 90 days |
| Regulatory Model | H8300 |
| Approvals | UL60950-1/cUL (USA and Canada), FCC Part 15, Class B (USA), CE (Europe), S-Mark (Argentina), GOST (Russia), KC (Korea), Safety Mark (Singapore), CCC, CECP (China), C-Tick (Australia/NZ) |
| Security | Cable Lock |

* Product specifications, terms, and offerings are subject to change at any time without notice.

** Actual lamp life may vary based on the ambient environment and projector usage. Conditions that may affect lamp life include temperature, altitude, and rapidly switching the projector on and off.

*** Tested to contain particles larger than the specified size in any dimension



InFocus
ScreenPlay



HDMI
HIGH-DEFINITION MULTIMEDIA INTERFACE